

Battery Backup Kit

Wiring and Installation Instructions

BATTERY BACKUP PACK ATS/SDO -
SAP# ORDER NO. 86643

ITEM	DESCRIPTION	QTY
1	BATTERY 12PCA 1.3 - 12V1.3 AH	2
2	BATTERY COUPLING WIRE F1	1
3	RECHARGABLE BATTERY LABEL	1

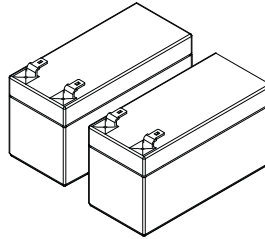

SPECIFICATIONS

APPROXIMATE NUMBER OF CYCLES UNDER BATTERY POWER	10
AVERAGE CYCLE TIME UNDER BATTERY POWER (OPENING AND CLOSING)	40 SECS
BATTERY CAPACITY (AMP HOURS)	1.3 AH
TIME FOR RE-CHARGE	24 HOURS

Important Safety Instructions



WARNING!

- **DO NOT** short the output of batteries. **Serious personal injury** and/or property damage can result from failure to follow this warning
- During charging and discharging cycles the lead-acid batteries may release explosive gases. Ensure that the area around the batteries is well ventilated
- Take care not to allow any metal objects to make contact with the positive and negative terminals. This will short circuit the battery causing sparks and possible damage to the battery, or even cause an explosion.



ELECTROCUTION!

- The battery box unit should be installed away from sprinkler systems.
- **DO NOT** immerse in water or spray directly with a hose or other device.
- Disconnect the power cord from mains power before making any repairs or removing covers.



CAUTION:

Fall from ladder

Burns

- Ensure ladder is the correct type for job.
- Ensure ladder is on flat ground.
- Ensure user has 3 points of contact while on ladder.
- **DO NOT** handle damaged or leaking batteries
- Wear appropriate protective clothing and avoid touching your eyes after working with batteries.
- The battery backup kit contains sealed lead-acid batteries that must be disposed of properly at the end of their useful life.

Maintenance

To ensure a long trouble free life for your battery backup it is recommended you run the testing procedure on a monthly basis. Batteries should not need replacing for 4 - 5 years.

Testing Procedure:

- a. Press the transmitter to activate the opener.
- b. Whilst the door is in motion disconnect power. The door should complete the cycle as normal.
- c. Wait for the door to finish its travel.
- d. Press the transmitter to activate the opener.
- e. Whilst the door is in motion reconnect power. If the door stopped or moved very slowly under battery power, ensure mains power is connected for 24 hours to recharge the batteries. Test the opener again under battery power to ensure batteries are working effectively.

Overhead Door Opener Set Up

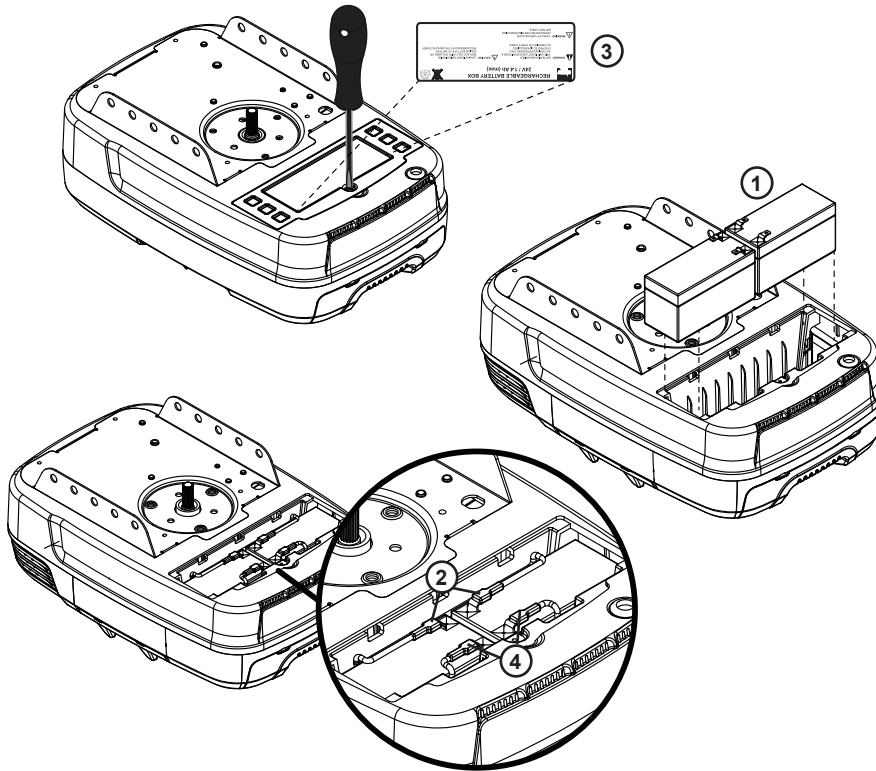

Mount and connect battery

- Unplug the drive unit from mains power.
- Stick the rechargeable battery label (3) to the cover before removing screw and opening the cover.
- Place the batteries (1) into the unit as shown.



WARNING: After Step (d) the opener may become active (even when power is off). This is a result of a residual charge in the batteries.

- The coupling wire (2) connects the batteries together and the battery harness (4) connects the batteries to the unit (polarity is red to red and black to black).
- Close the cover, securing with screw and reconnect power.

NOTE: Batteries may take up to 24 hours to charge fully after initial installation.

Re-setup and Test the Opener

- Press either the OPEN or CLOSE button to test the battery backup installation.
- Whilst door is in motion, disconnect mains power. The door should continue to operate as normal.

NOTE: Wait for the door to complete its travel.

- Press either the OPEN or CLOSE button to activate the door.
- Whilst door is in motion, reconnect power. The door should complete the cycle as normal.

Troubleshooting

Symptom	Possible cause	Remedy
Door stops or moves very slowly under battery power	Batteries may be weak or have no charge	Connect mains power and allow the batteries to charge. This may take 24 hours to reach maximum charge capacity.
Door will not operate when mains power is disconnected.	Batteries may not be connected properly.	Check wiring.
	Batteries may have no charge	Connect mains power and allow the batteries to charge. This may take 24 hours to reach maximum charge capacity.
	Faulty Batteries	Disconnect the batteries from the board. Check the voltage of the each battery. Voltage should not drop below 10V.

LED indicator (yellow)

Status	Opener Battery LED
Battery not used	Stays off
Battery charging	Flashing 1 sec on and 1 sec off
Battery charged	Solid on
Battery in use	Flashing 0.2 sec on and 1.8 sec off
Battery failed	Flashing 0.2 sec on and 0.2 sec off

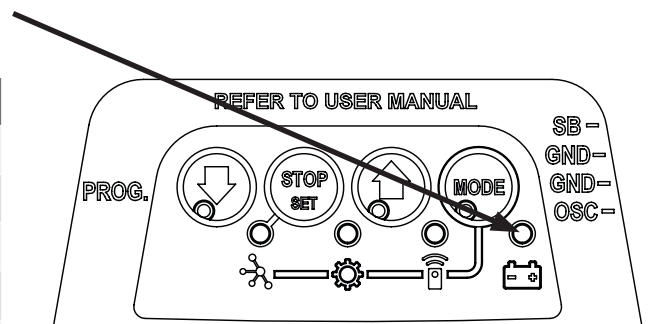

WARRANTY

ACCESSORIES	1 year
-------------	--------

This warranty is to be read in conjunction with the owner's copy of the opener installation instruction.